

# Information on Application and Permission Stamp Counters

The scope of services offered at Application Counters (on the 2<sup>nd</sup> floor) of the Tokyo Regional Immigration Bureau was changed effective Friday, April 1, 2011, as follows:

Type of Application, etc.	Counter in charge
<p>Applications concerning Residence in general</p> <ul style="list-style-type: none"> <li>○Application for Extension of Period of Stay</li> <li>○Application for Change of Status of Residence</li> <li>○Application for Permission to Acquire Status of Residence</li> <li>○Application for Permission for Permanent Residence</li> <li>○Application for Re-entry Permission simultaneously submitted along with other applications to change the status of residence or extend the period of residence, etc.</li> <li>○Application for Permission to Engage in Activity Other Than That Permitted by the Status of Residence Previously Granted</li> <li>○Application for a Certificate of Authorized Employment</li> </ul>	Application Counter B, 2nd floor (Residence)
<p>Applications for issuance of all types of Certificates of Eligibility</p>	Certificate Application Counter C, 2nd floor (Entry)
<p>○ Provision of Permission Stamps for all applications concerning residence; Issuance and transcription of Permission Stamps to Permit Deviation of Status and Certificate of Authorized Employment</p> <p>Please note that:</p> <ol style="list-style-type: none"> <li>1. Transcription limited to Permission Stamp for Re-entry is provided at Re-entry Counter D, 2nd floor, and</li> <li>2. Transcription of Permission Stamp for Special Permission for Residence is issued at the Judgment Division (6<sup>th</sup> floor).</li> </ol> <p>○ Application for Cancellation of Status of Residence</p> <p>Cancellation of Status of Residence for Short Stay is accepted at the Division of Training/Short Stay Examination.</p>	Permission Stamp Counter A, 2nd floor
<p>Application and Permission Stamp for Re-entry (Except for application for Re-entry Permission simultaneously submitted along with other applications to change the status of residence or extend the period of residence, etc.)</p>	Re-entry Permission Counter D, 2nd floor
<p>Procedure on Vessels</p>	Vessels Procedure Counter C, 2nd floor

# 1F

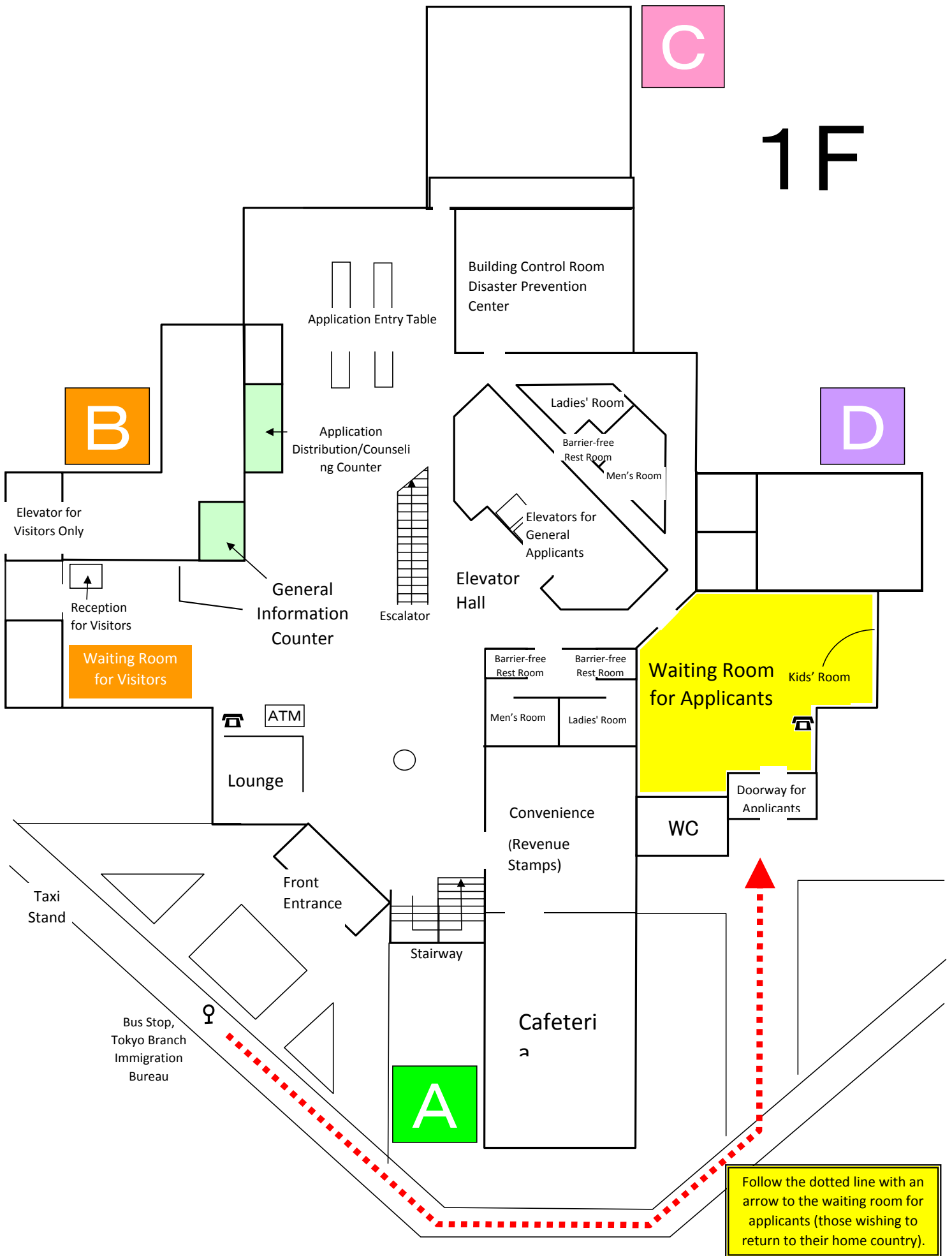

Follow the dotted line with an arrow to the waiting room for applicants (those wishing to return to their home country).

# 2F

\*First, take a number ticket at the counter concerned.

